







- i**
- MICRO
- TITAN
- TPH
- TPS
- TPSP
- TPF
- TPK
- TPC
- TPR
- TPB
- TPHC
- TPA
- TPG
- TPCT
- TPSL
- STOP CYLINDER
- STOP CYLINDER
- TPSR
- TPSRS
- TPNS
- TPHT
- 
- 
- 
- 
- 
- 



Code	A mm	B mm	C mm
TPRCS 15000x50	190	56	88
TPRCS 15000x80	220	86	118
TPRCS 15000x100	260	126	158

Code	Smax mm	Max. punching force	Gas spring force		Gas spring model	ISO VDI	Max. working specs		Max. width of driver	Kg
			Initial daN	Final daN			Velocity	Strokes / min		
TPRCS 15000x50-1	50	15000 daN	400	≈ 580	2x TPC 25x50.1 YW	✓	0,5 m/s	25 spm	65 mm	26,3
TPRCS 15000x50-2			640	≈ 1050	2x MICRO25V1x50 YW					
TPRCS 15000x80-1	80		400	≈ 580	2x TPC 25x80.1 YW	✓	20 spm	30,8		
TPRCS 15000x80-2			640	≈ 1050	2x MICRO25V1x80 YW					
TPRCS 15000x100-1	100		400	≈ 580	2x TPC 25x100.1 YW	✓	20 spm	30,8		
TPRCS 15000x100-2			640	≈ 1050	2x MICRO25V1x100 YW					

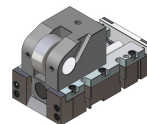
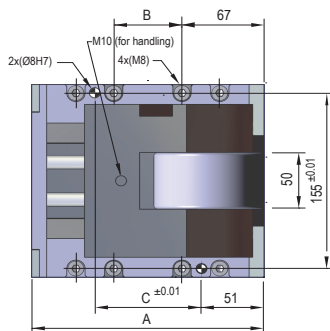
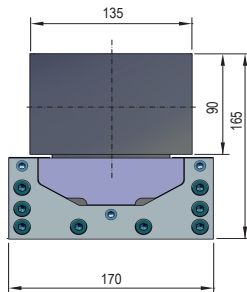
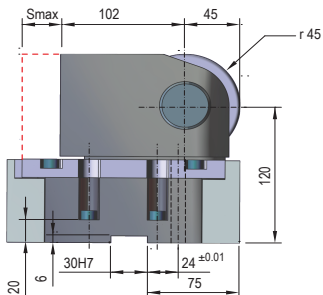
Working force distribution

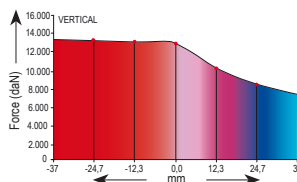
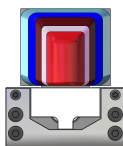
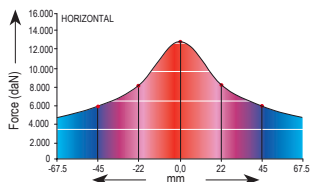

Maximum force that can be applied to the punch depending on eccentricity, so that the stress in the assembly is the same as it was when the punch was completely centred.

How to order

TPRCS 15000	x	50	-	1
Code		Stroke		Gas spring model
				TPC 25.1 MICRO 25V1

Maximum inclination

